

GF2786

BEAM CLAMPS

Wt/100pcs 92 Lbs

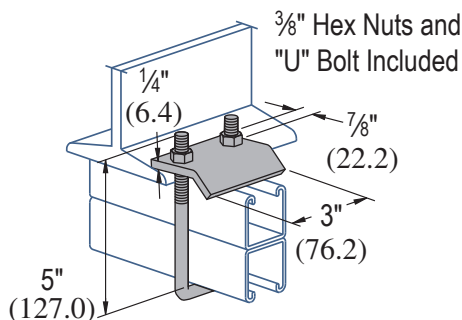

- For use with beams up to 3/4" flange thickness and Channels, CH1001, CH5000, CH5500..

Design Load Each
1000 Lbs
Use in Pairs Only

Materials & Finishes: EG

Material Specifications			
Material	Material Code	ASTM Designation	ASTM Description
Steel:	Use Finish Code	ASTM A1011 SS GR 33.	UBS channels are accurately and carefully cold formed to size from low-carbon strip steel. 12 Ga., 14 Ga. & 16 Ga.

Finish Specifications		
Finish	Finish Code	Description
Zinc Electroplated	EG	Zinc electroplating is used to coat plain steel. The electroplating process requires that the component be immersed in a solution containing zinc ions that are deposited on the surface of the part.

PROJECT INFORMATION:		APPROVAL STAMP:
Project:		
Date:	Phone:	
Architect / Engineer:		
Contractor:		
Address:		
Notes 1:		