

## GF2785

### BEAM CLAMPS

Wt/100pcs 83 Lbs

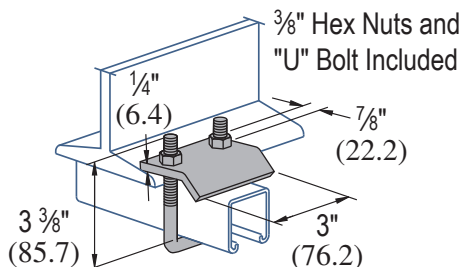

- For use with beams up to 3/4" flange thickness and Channels, CH1000, CH1100, CH2000, CH3000, CH3300, CH3301, CH4000, CH4100.

Design Load Each  
1000 Lbs  
Use in Pairs Only

Materials & Finishes: EG, SS

Material Specifications			
Material	Material Code	ASTM Designation	ASTM Description
Steel:	Use Finish Code	ASTM A1011 SS GR 33.	UBS channels are accurately and carefully cold formed to size from low-carbon strip steel. 12 Ga., 14 Ga. & 16 Ga.
[Stainless Steel:	SS304	A 240 TYPE 304	Heat resisting chromium and chromium-nickel stainless steel plate, sheet, strip for pressure vessel.
	SS316	A 240 TYPE 316	

Finish Specifications		
Finish	Finish Code	Description
Zinc Electroplated	EG	Zinc electroplating is used to coat plain steel. The electroplating process requires that the component be immersed in a solution containing zinc ions that are deposited on the surface of the part. Electroplated zinc is shiny and smooth, and is suitable for indoor environments with low relative humidity.

PROJECT INFORMATION:		APPROVAL STAMP:
<b>Project:</b>		
<b>Date:</b>	<b>Phone:</b>	
<b>Architect / Engineer:</b>		
<b>Contractor:</b>		
<b>Address:</b>		
<b>Notes 1:</b>		