

## CCT025 - CCT412

### CLAMPS & PIPE SUPPORTS

#### TUBE CUSHIONED CLAMPS

Other sizes available by request

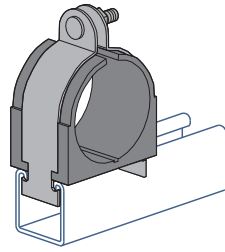

Controlled Squeeze  
Shoulder Bolt  
on sizes up to 1 3/8" OD

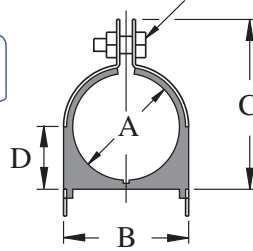

- Cushion material is a thermoplastic elastomer rated from -65°F to 248°F (-53°C to 120°C).
- Resist most fuels, oils, gases, greases, solvents, mineral acids and other harsh materials.
- Allow fluid conductors to be added or removed from installations without disturbing adjacent lines.
- Permit various size lines to be mixed to suit installation.
- Available in 304 and 316 stainless steel. Aluminum offered for special orders.

Part Number	Copper & Steel Tube O. D. Size	Copper Water Pipe (Nominal)	Dimensions In(mm)				Wt/100 pcs Lbs
			"A"	"B"	"C"	"D"	
CCT025	1/4"	—	0.25 6.4	0.62 15.7	0.98 24.9	0.27 6.9	10
CCT037	3/8"	1/4"	0.37 9.4	0.82 20.8	1.13 28.7	0.33 8.4	11
CCT050	1/2"	3/8"	0.5 12.7	0.94 23.9	1.34 34.0	0.4 10.2	13
CCT062	5/8"	1/2"	0.62 15.7	1.06 26.9	1.54 39.1	0.46 11.7	14
CCT075	3/4"	5/8"	0.75 19.1	1.2 30.5	1.68 42.7	0.52 13.2	14
CCT087	7/8"	3/4"	0.87 22.1	1.31 33.3	1.82 46.2	0.58 14.7	15
CCT100	1"	—	1.00 25.4	1.44 36.6	1.95 49.6	0.65 16.6	17
CCT112	1 1/8"	1"	1.12 28.4	1.57 39.9	2.08 52.8	0.7 17.8	18
CCT125	1 1/4"	—	1.25 31.8	1.70 43.2	2.21 56.1	0.77 19.6	18
CCT137	1 3/8"	1 1/4"	1.37 34.8	1.82 46.2	2.34 59.4	0.83 21.1	20
CCT150	1 1/2"	—	1.50 38.1	1.95 49.6	2.47 62.7	0.90 22.9	33

Materials & Finishes: EG, SS

Material Specifications			
Material	Material Code	ASTM Designation	ASTM Description
Steel:	Use Finish Code	ASTM A1011 SS GR 33.	UBS channels are accurately and carefully cold formed to size from low-carbon strip steel. 12 Ga., 14 Ga. & 16 Ga.
[Stainless Steel:	SS304	A 240 TYPE 304	Heat resisting chromium and chromium-nickel stainless steel plate, sheet, strip for pressure vessel.
	SS316	A 240 TYPE 316	

Part Number	Copper & Steel Tube O. D. Size	Copper Water Pipe (Nominal)	Dimensions In(mm)				Wt/100 pcs Lbs
			"A"	"B"	"C"	"D"	
CCT162	1 5/8"	1 1/2"	1.62 41.1	2.07 52.6	2.6 66.0	0.96 24.4	35
CCT175	1 3/4"	—	1.75 44.5	2.2 55.9	2.73 69.3	1.02 25.9	37
CCT187	1 7/8"	—	1.9 48.3	2.35 59.7	2.86 72.6	1.09 27.7	39
CCT200	2"	—	2.00 50.8	2.45 62.2	3.04 77.2	1.15 29.2	41
CCT212	2 1/8"	2"	2.12 53.8	2.57 65.3	3.23 82.0	1.27 32.3	46
CCT237	2 3/8"	—	2.37 60.2	2.82 71.6	3.67 93.2	1.41 35.8	47
CCT250	2 1/2"	—	2.5 63.5	2.94 74.7	3.79 96.3	1.46 37.1	49
CCT262	2 5/8"	2 1/2"	2.62 66.5	3.1 78.0	3.92 99.6	1.53 38.9	51
CCT300	3"	—	3.00 76.2	3.57 90.7	4.42 112.3	1.78 45.2	57
CCT312	3 1/8"	3"	3.12 79.2	3.6 90.7	4.42 112.3	1.78 45.2	60
CCT362	3 5/8"	3 1/2"	3.62 91.9	4.2 106.7	4.99 126.7	2.03 51.6	70
CCT412	4 1/8"	4"	4.12 104.6	4.6 116.1	5.54 140.7	2.34 59.4	94

Finish Specifications		
Finish	Finish Code	Description
Zinc Electroplated	EG	Zinc electroplating is used to coat plain steel. The electroplating process requires that the component be immersed in a solution containing zinc ions that are deposited on the surface of the part. Electroplated zinc is shiny and smooth, and is suitable for indoor environments with low relative humidity.

PROJECT INFORMATION:		APPROVAL STAMP:			
Project:					
Date:	Phone:				
Architect / Engineer:					
Contractor:					
Address:					
Notes 1:					